

**Bolts**



**Technical data**

Industry

Industrial

Piston diameter

152.4 mm

**Material**

Housing material

Steel, chrome-plated

Part No.

R433012627

**Dimensions in inches**

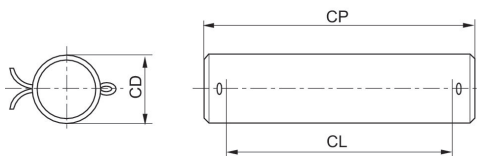

## Dimensions in inches

Part No.	CD	CL	CP
R433012619	0.5	1.88	2.09
R433012621	0.75	2.62	2.88
R433012623	1.00	3.12	3.38
R433012625	1.375	4.00	4.63
R433012627	1.750	5.00	5.63