

Single subbase, thread connections on the side

R432031845



Technical data

Industry
Industrial

Type
Base plate

Direction of pneumatic port (1)
On the side

Compressed air connection input
3/8 NPTF

Compressed air connection output
3/8 NPTF

Direction of pneumatic port (3,5)
On the side

Port exhaust
3/8 NPTF

Standards
ISO 5599-1

Working pressure min.
-0.95 bar

Exhaust type
Ports separated

Exhaust (3,5)
With directional exhaust (3/5)

Direction of pneumatic port (12)
On the side

Compressed air connection 12
1/8" NPTF

Direction of pneumatic port (14)
On the side

Compressed air connection 14
1/8" NPTF

Working pressure max
16 bar

Min. ambient temperature
-25 °C

Max. ambient temperature
70 °C
Min. medium temperature
-25 °C

Max. medium temperature
70 °C
Medium
Compressed air

Max. number of valve positions
1

Weight
0.1 kg

Material

Material base plate
Die-cast aluminum

Part No.
R432031845

Technical information

For use with HV series valves, the ambient temperature is -25 °C...200 °C and the medium temperature is -25 °C...120 °C.

Reversed pressure supply is not permitted for HV series valves.

The min. control pressure must be adhered to, since otherwise faulty switching and valve failure may result!

The pressure dew point must be at least 15 °C under ambient and medium temperature and may not exceed 3 °C .

The oil content of compressed air must remain constant during the life cycle.

Use only the approved oils from AVENTICS. Further information can be found in the "Technical information" document (available in <https://www.emerson.com/en-us/support>).

Dimensions in inches

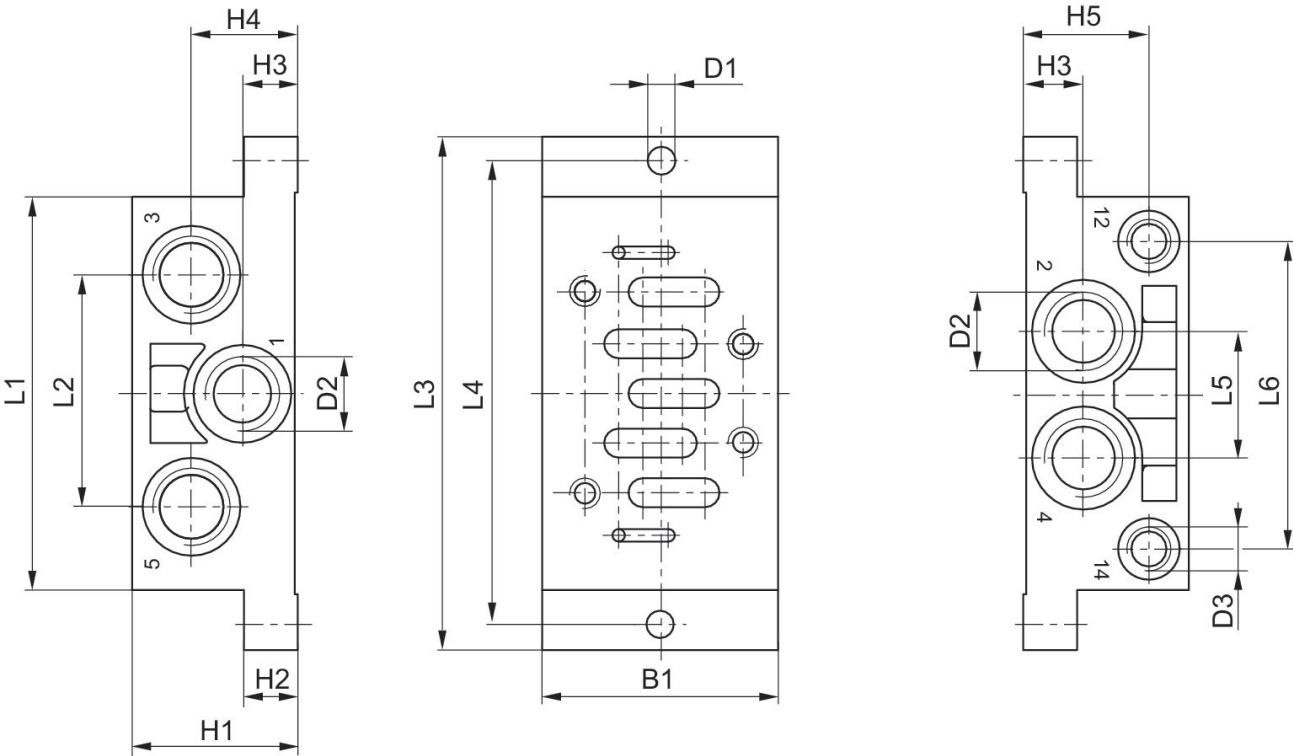

Dimensions in inches

Part No.	B1	H1	H2	H3	H4	H5	D1	D2 *)	D3 *)
R432031845	2.2	1.57	0.51	0.55	1.02	1.18	0.26	3/8" NPTF	1/8" NPTF

L1	L2	L3	L4	L5	L6
3.74	2.2	4.88	4.41	1.18	2.91

*) Ports