

## AVENTICS Series ST4 Magnetic proximity sensors

The AVENTICS Series ST4-2P sensors make it possible to measure any two switching points in a 50 mm range using just one sensor in a 4 mm C-slot. As a result, there is no need to install a second sensor, making the process easier, faster and more precise. Assembly and cabling effort are also halved. A serial interface is provided for diagnosis and configuration.

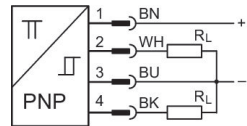

## Technical data

Industry

Direct mounting for series

Indirect mounting for series

Slot width

Version

number of switching points

Cable

Type of contact

Hysteresis

Certificates

Protection class

Min. ambient temperature

Max. ambient temperature

Max. detection range

Voltage drop U at I<sub>max</sub>

Max. DC switching current

Switching logic

Display

Display

LED status display

Electrical connection 2, type

Electrical connection 2, number of poles

Industrial

PRA

SSI

RTC

GPC

MSC

MSN

RCM

CVI

MNI

CSL-RD

ICM

4 mm C-slot

2 switching points

2

with cable

electronic PNP

1 mT

RoHS

IP67

-20 °C

75 °C

50 mm

≤ 2,2 V

0.15 A

NO (make contact)

2 LED

LED

Yellow

without wire end ferrule, tin-plated

4-pin

Min. operating voltage DC	12 V DC
Max. operating voltage DC	30 V DC
Short circuit resistance	short circuit resistant Protected against polarity reversal
Shock resistance	30 g / 11 ms
Vibration resistance	10 - 55 Hz, 1 mm
Cable length L	2 m
Mounting screw	with hexagon socket

## Material

Housing material	Polyamide
Material cable sheath	Polyurethane
Part No.	R412010139

## Technical information

The pressure dew point must be at least 15 °C less than ambient and medium temperature and may not exceed 3 °C.

The oil content of compressed air must remain constant during the life cycle.

Use only the approved oils from AVENTICS. Further information can be found in the “Technical information” document (available in <https://www.emerson.com/en-us/support>).

## Dimensions

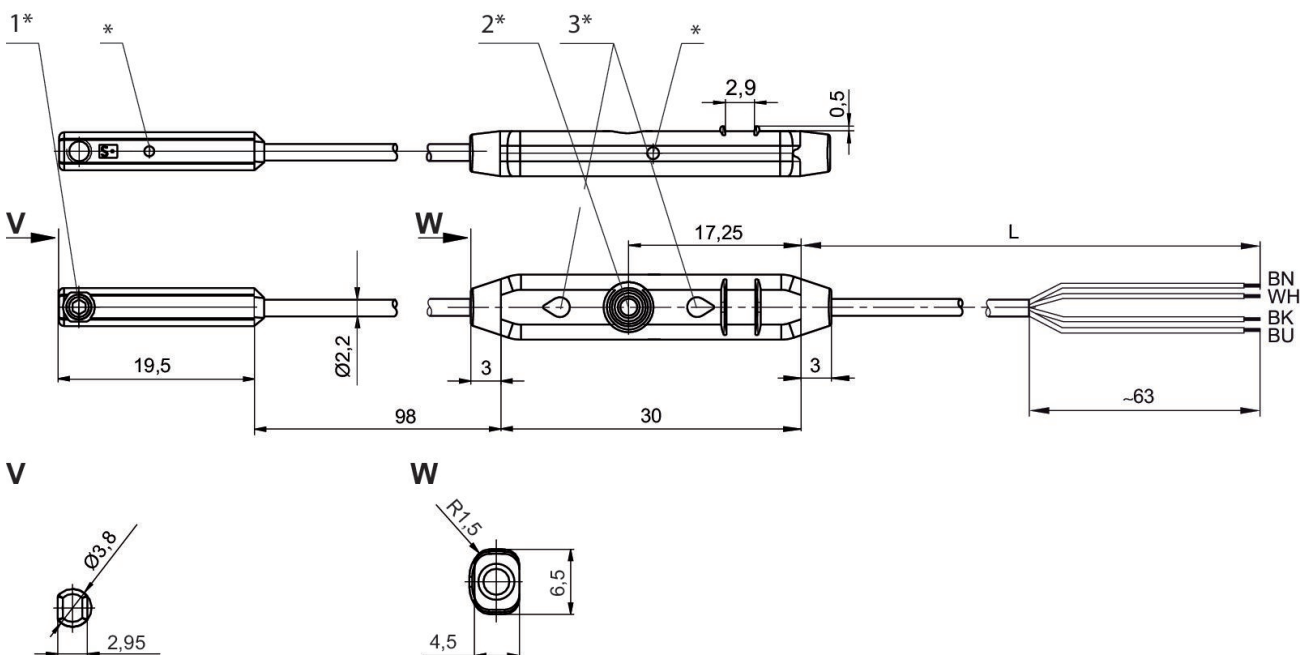

1\* = mounting screw 2\* = teach button 3\* = LED  
L = cable length  
(2) WH=white

# Sensors, Series ST4-2P

R412010139

ST4-2P

2023-10-25

---

\* Switching point