

Series AS3

The AVENTICS Series AS3 is a modular, versatile maintenance unit for universal application. This Series offers compact dimensions, is highly efficient, lightweight and easy-to-use. The AVENTICS Series AS guarantees reliability, safety, and efficiency with a simplified assembly and maintenance efforts.

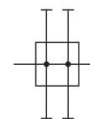

Technical data

Industry	Industrial
Parts	Distributor
Port	G 3/8
Type	Can be assembled into blocks
Version	Distributor 4x
Mounting orientation	Any
Min. working pressure	0 bar
Max. working pressure	16 bar
Min. ambient temperature	-10 °C
Max. ambient temperature	50 °C
Medium	Compressed air Neutral gases
Nominal flow Qn	7250 l/min
Nominal flow Qn 1 to 2	7250 l/min
Nominal flow Qn 1 to 3	5500 l/min
Nominal flow Qn 1 to 4	2300 l/min
Nominal flow Qn 1 to 5	2250 l/min
Nominal flow Qn 1 to 6	2300 l/min
Weight	0.32 kg
Housing material	Polyamide

Material front plate

Acrylonitrile butadiene styrene

Seal material

Acrylonitrile butadiene rubber

Material threaded bushing

Die cast zinc

R412007250

Technical information

The pressure dew point must be at least 15 °C less than ambient and medium temperature and may not exceed 3 °C.

Suitable for direct mounting of a PE2 and PM1 series pressure sensor (flange version).

Nominal flow Qn with secondary pressure p2 = 6 bar at $\Delta p = 1$ bar

A change in the flow direction (from air supply on the left to air supply on the right) occurs by rotating installation by 180° about the vertical axis. Please see the operating instructions for further details.

Dimensions

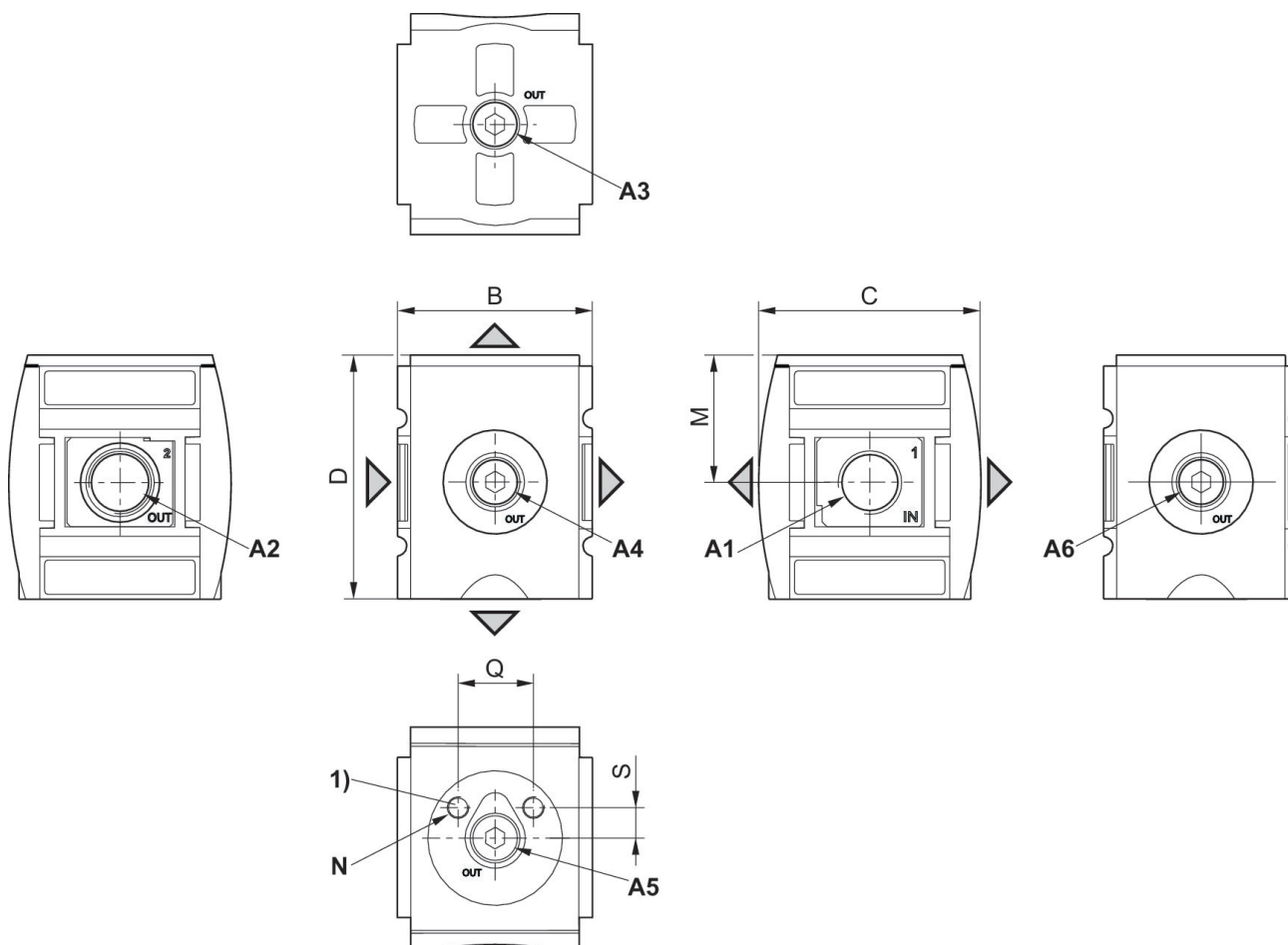

A1 = input A2 = output A3 = output A4 = output A5 = output A6 = output

1) Mounting thread for pressure sensor

Accessories overview

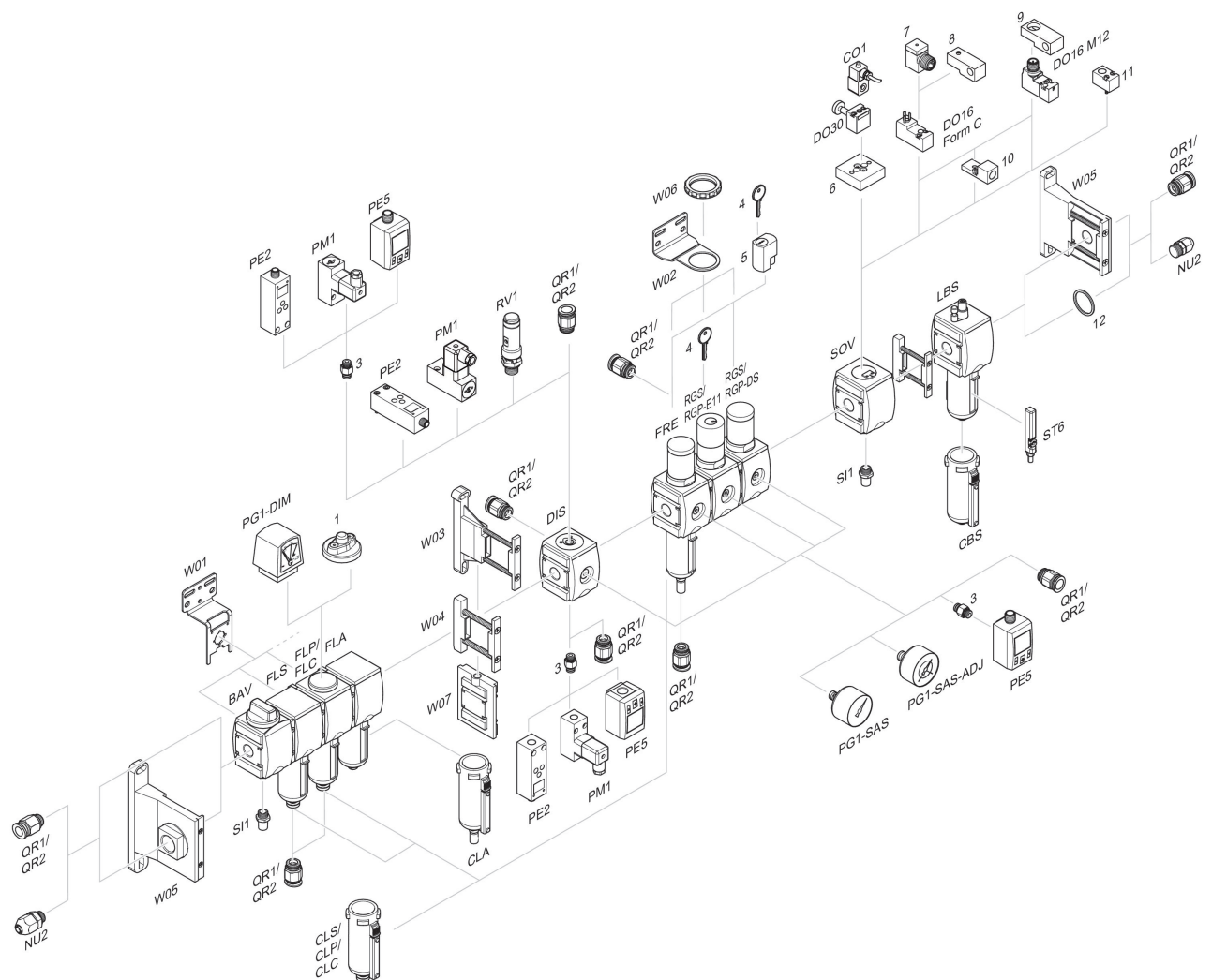

1 = contamination display 3 = Double nipple 4 = Key for E11 locking 5 = mortise lock 6 = Transition plate DO30 7 = Adapter, Series CON-VP 8 = Mounting aid DO16, form C 9 = Mounting aid DO16, M12 10 = Adapter for external pilot air 11 = Adapter pneumatic operation 12 = Sealing ring

Dimensions in mm

Part No.	A1	A2	A3	A4	A5	A6	B	C	D
R412007250	G 3/8	G 3/8	G 1/2	G 3/8	G 1/4	G 3/8	63	74	80.5
R412007251	G 1/2	G 1/2	G 1/2	G 3/8	G 1/4	G 3/8	63	74	80.5

M	N	Q	S
42.5	M5	20	8
42.5	M5	20	8