

Transition plate, Series 355, ISO 2

88135507

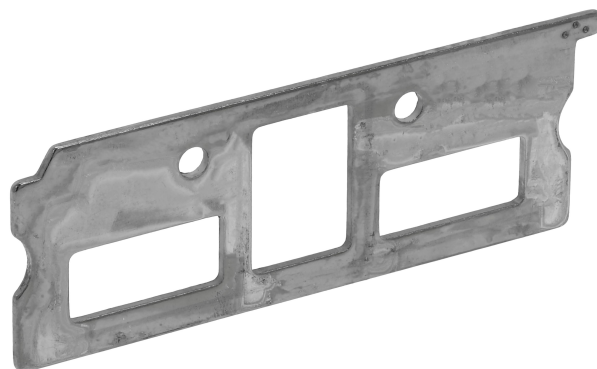

Technical data

Type

Port 1, 3, 5 open

Frame size

ISO 2

Min. ambient temperature

-10 °C

Max. ambient temperature

60 °C

Material

Material base plate

Galvanized Steel

Part No.

88135507

Technical information

The min. control pressure must be adhered to, since otherwise faulty switching and valve failure may result!

The pressure dew point must be at least 15 °C under ambient and medium temperature and may not exceed 3 °C .

Dimensions

