

## Series CH02

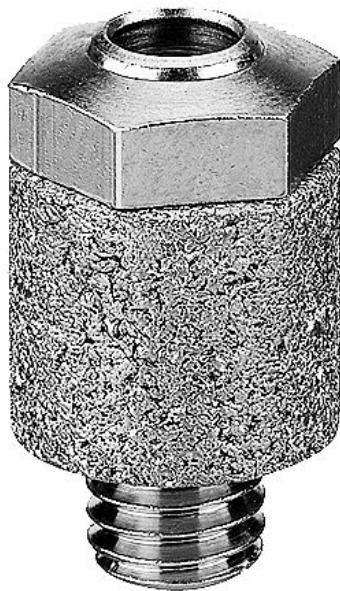

**AVENTICS™**

**AVENTICS Series CH02 Throttle  
valves**

  
**EMERSON™**

**Series CH02**

Series CH throttle valves can be used for nominal flows up to 4,100 l/min. The Series features special versions with integrated silencer and screw-in variants.

- $Q_n = 200 \text{ l/min} \dots 4100 \text{ l/min}$

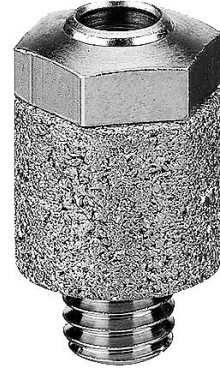

## Product overview

### Throttle valve

	Page
Throttle valve, Series CH02..... Ambient temperature: -25 ... 60°C	4
Throttle valve, Series CH02..... Ambient temperature: -25 ... 80°C	5
Throttle valve, Series CH02..... Ambient temperature: 0 ... 100°C	7

**Throttle valve, Series CH02**

Silencer material: Polyethylene

Ambient temperature min./max.: -25 °C ... 60 °C

Working pressure min./max.: 0 bar ... 10 bar



Input	Flow [l/min]	Part No.
Ø 8	1300	3341052010

Dimensions

SW17

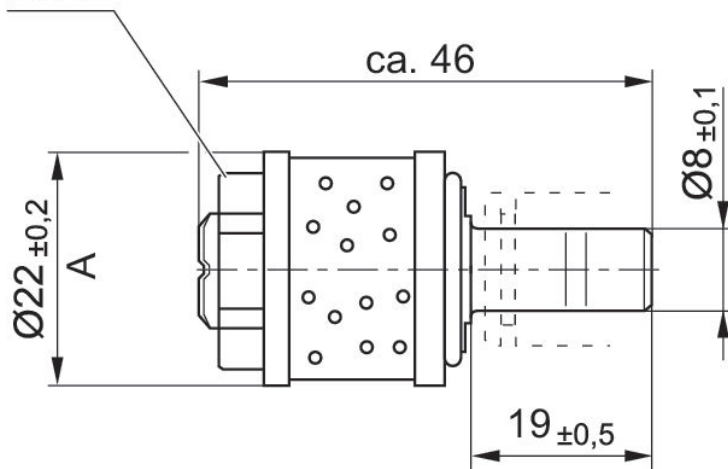

**Throttle valve, Series CH02**

Silencer material: Stainless Steel  
 Ambient temperature min./max.: -25 °C ... 80 °C  
 Medium temperature min./max.: -25 °C ... 80 °C  
 Working pressure min./max.: 0 bar ... 10 bar

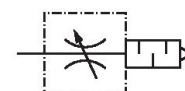
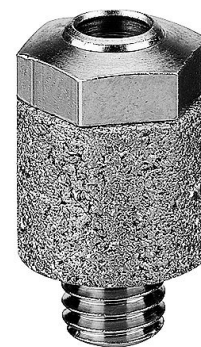

Input	Flow [l/min]	Part No.
M5	200	0821201101
G 1/8	700	0821201102
G 1/4	1700	0821201103
G 3/8	3100	0821201104
G 1/2	4100	0821201105

Dimensions

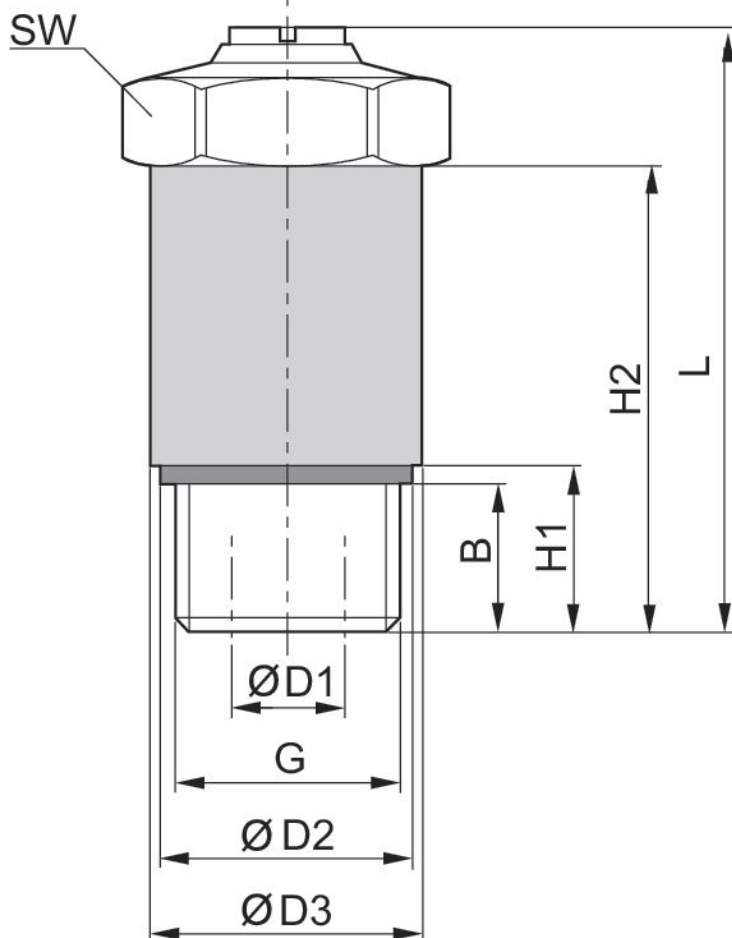

Part No.	Port G	Ø D1	Ø D2	Ø D3	H1	H2	B	L 1)	SW
0821201101	M5	2	7.7	9	3.8	12	12	16.6	8
0821201102	G 1/8	4	13	16	7	24	5.5	31.5	13
0821201103	G 1/4	6.5	17.9	20	10	30	8	37.5	17
0821201104	G 3/8	8.5	21.8	25	10	35	8	45	19
0821201105	G 1/2	12	26.5	30	12	42	10	52	24

1) Max.

**Throttle valve, Series CH02**

Ambient temperature min./max.: 0 °C ... 100 °C  
 Medium temperature min./max.: 0 °C ... 100 °C  
 Working pressure min./max.: 0 bar ... 16 bar

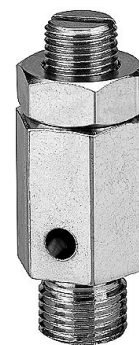

Input	Flow [l/min]	Part No.
G 1/8	475	0821201001
G 1/4	750	0821201002
G 1/2	3000	0821201003

Dimensions

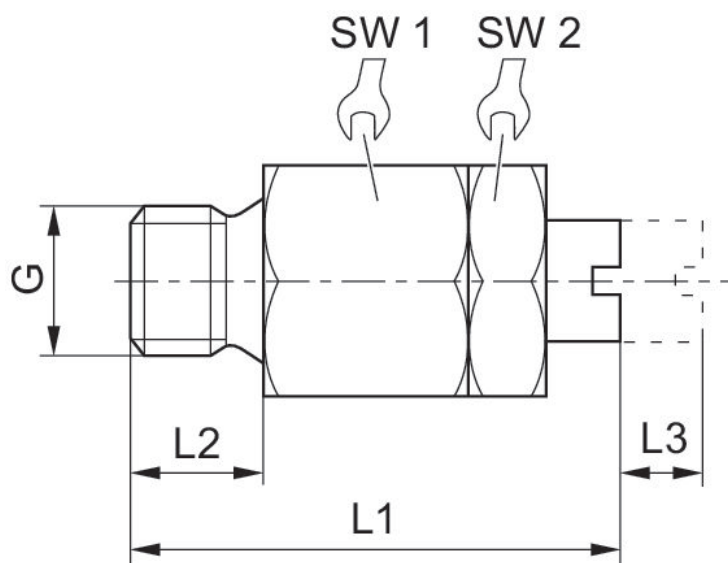





Part No.	Port G	L1	L2	L3	SW1	SW2
0821201001	G 1/8	34	8	5	13	13
0821201002	G 1/4	33	8	6.5	17	14
0821201003	G 1/2	50	10	8	27	22

Efficient pneumatic solutions, our program:  
cylinders and drives, valves and valve systems,  
air supply management, proportional pressure  
control valves



Visit us: [www.Emerson.com/aventics](http://www.Emerson.com/aventics)  
Your local contact: [Emerson.com/contactus](http://Emerson.com/contactus)

-  [Emerson.com](http://Emerson.com)
-  [Facebook.com/EmersonAutomationSolutions](https://Facebook.com/EmersonAutomationSolutions)
-  [LinkedIn.com/company/Emerson-Automation-Solutions](https://LinkedIn.com/company/Emerson-Automation-Solutions)
-  [Twitter.com/EMR\\_Automation](https://Twitter.com/EMR_Automation)



The Emerson logo is a trademark and service mark of Emerson Electric Co. AVENTICS is a registered trademark of one of the Emerson family of companies. All other trademarks are the property of their respective owners. © 2020 Emerson Electric Co. All rights reserved.



**CONSIDER IT SOLVED™**