

Serie CH02

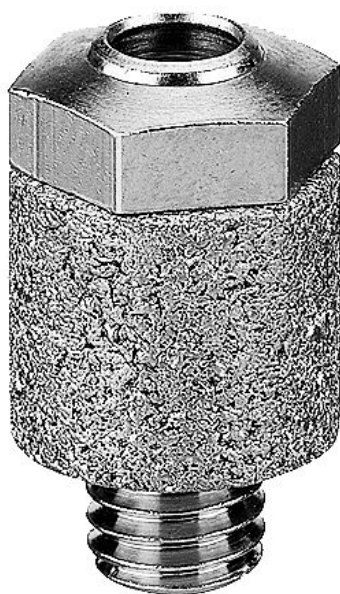

AVENTICS™

**AVENTICS Serie CH02
Drosselventile**

EMERSON™

Serie CH02

Drosselventile der Serie CH eignen sich für Nenndurchflüsse von bis zu 4 100 l/min. In der Serie gibt es besondere Versionen mit integriertem Schalldämpfer und einschraubbare Varianten.

- $Q_n = 200 \text{ l/min} \dots 4100 \text{ l/min}$

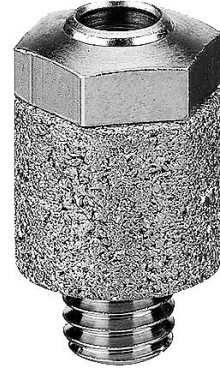

Produktübersicht

Drosselventil

| | Seite |
|---|-------|
| Drosselventil, Serie CH02..... Umgebungstemperatur: -25 ... 60°C | 4 |
| Drosselventil, Serie CH02..... Umgebungstemperatur: -25 ... 80°C | 5 |
| Drosselventil, Serie CH02..... Umgebungstemperatur: 0 ... 100°C | 7 |

Drosselventil, Serie CH02

Werkstoff Schalldämpfer: Polyethylen
 Umgebungstemperatur min./max.: -25 °C ... 60 °C
 Betriebsdruck min./max.: 0 bar ... 10 bar



| Eingang | Durchfluss [l/min] | Materialnummer |
|---------|--------------------|----------------|
| Ø 8 | 1300 | 3341052010 |

Abmessungen

SW17

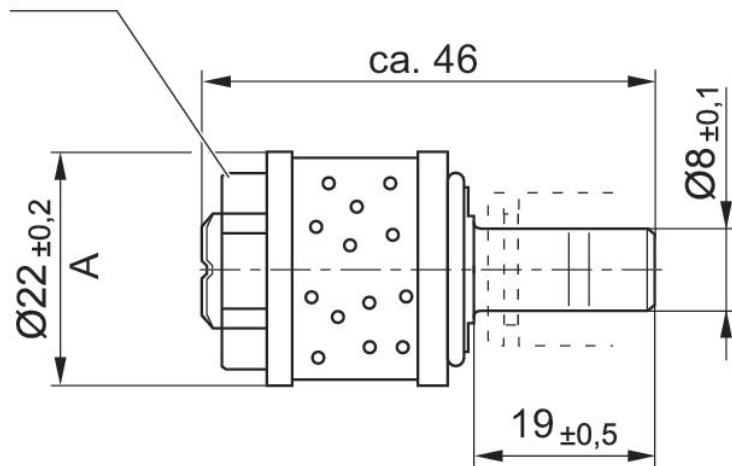

Drosselventil, Serie CH02

Werkstoff Schalldämpfer: Nichtrostender Stahl
 Umgebungstemperatur min./max.: -25 °C ... 80 °C
 Mediumtemperatur min./max.: -25 °C ... 80 °C
 Betriebsdruck min./max.: 0 bar ... 10 bar

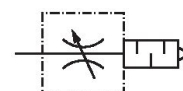
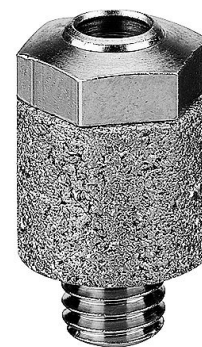

| Eingang | Durchfluss [l/min] | Materialnummer |
|---------|--------------------|----------------|
| M5 | 200 | 0821201101 |
| G 1/8 | 700 | 0821201102 |
| G 1/4 | 1700 | 0821201103 |
| G 3/8 | 3100 | 0821201104 |
| G 1/2 | 4100 | 0821201105 |

Abmessungen

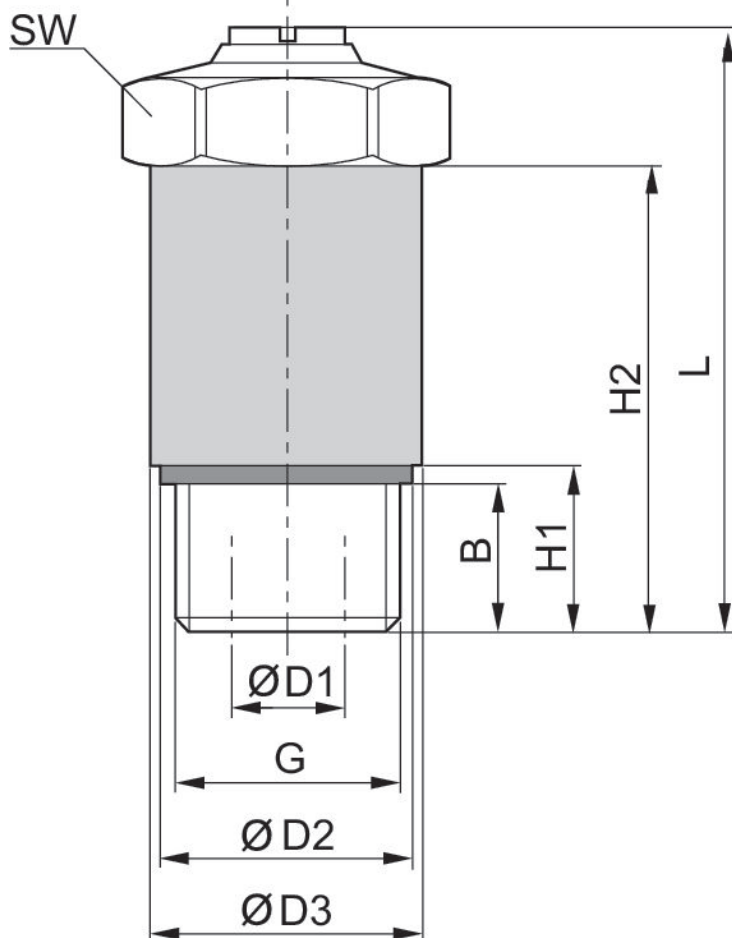

| Materialnummer | Anschluss G | Ø D1 | Ø D2 | Ø D3 | H1 | H2 | B | L 1) | SW |
|----------------|-------------|------|------|------|-----|----|-----|------|----|
| 0821201101 | M5 | 2 | 7.7 | 9 | 3.8 | 12 | 12 | 16.6 | 8 |
| 0821201102 | G 1/8 | 4 | 13 | 16 | 7 | 24 | 5.5 | 31.5 | 13 |
| 0821201103 | G 1/4 | 6.5 | 17.9 | 20 | 10 | 30 | 8 | 37.5 | 17 |
| 0821201104 | G 3/8 | 8.5 | 21.8 | 25 | 10 | 35 | 8 | 45 | 19 |
| 0821201105 | G 1/2 | 12 | 26.5 | 30 | 12 | 42 | 10 | 52 | 24 |

1) Max.

Drosselventil, Serie CH02

Umgebungstemperatur min./max.: 0 °C ... 100 °C
 Mediumtemperatur min./max.: 0 °C ... 100 °C
 Betriebsdruck min./max.: 0 bar ... 16 bar

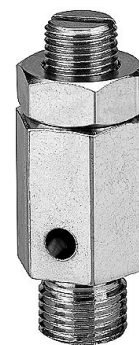

| Eingang | Durchfluss [l/min] | Materialnummer |
|---------|--------------------|----------------|
| G 1/8 | 475 | 0821201001 |
| G 1/4 | 750 | 0821201002 |
| G 1/2 | 3000 | 0821201003 |

Abmessungen

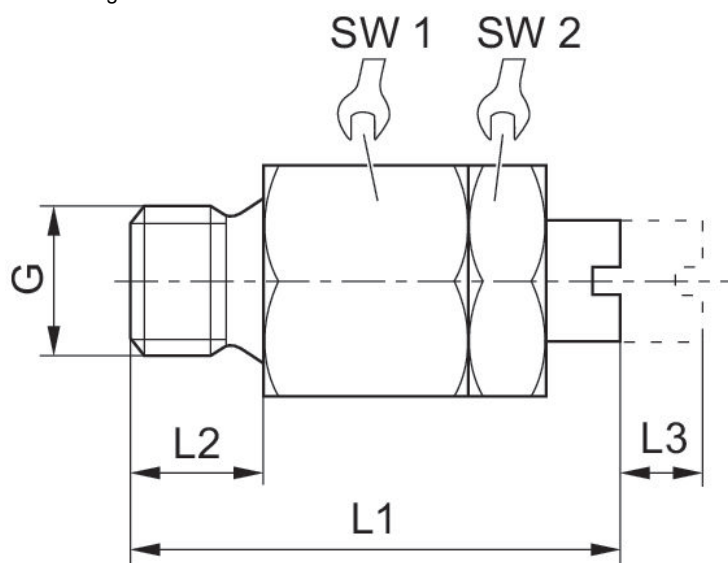





| Materialnummer | Anschluss G | L1 | L2 | L3 | SW1 | SW2 |
|----------------|-------------|----|----|-----|-----|-----|
| 0821201001 | G 1/8 | 34 | 8 | 5 | 13 | 13 |
| 0821201002 | G 1/4 | 33 | 8 | 6.5 | 17 | 14 |
| 0821201003 | G 1/2 | 50 | 10 | 8 | 27 | 22 |

Efficient pneumatic solutions, our program:
cylinders and drives, valves and valve systems,
air supply management, proportional pressure
control valves



Visit us: www.Emerson.com/aventics
Your local contact: Emerson.com/contactus

-  Emerson.com
-  Facebook.com/EmersonAutomationSolutions
-  LinkedIn.com/company/Emerson-Automation-Solutions
-  Twitter.com/EMR_Automation



The Emerson logo is a trademark and service mark of Emerson Electric Co. AVENTICS is a registered trademark of one of the Emerson family of companies. All other trademarks are the property of their respective owners. © 2020 Emerson Electric Co. All rights reserved.



CONSIDER IT SOLVED[®]