

# Single subbase, thread connections on the side

1825503149



## Technical data

Industry  
Industrial

Type  
Base plate

Direction of pneumatic port (1)  
On the side

Compressed air connection input  
G 1/2

Direction of pneumatic port (2,4)  
On the side

Compressed air connection output  
G 1/2

Direction of pneumatic port (3,5)  
On the side

Frame size  
ISO 3

Standards  
ISO 5599-1

Port exhaust  
G 1/2

Exhaust type  
Ports separated

Exhaust (3,5)  
With directional exhaust (3/5)

Direction of pneumatic port (12)  
On the side

Compressed air connection 12  
G 1/8

Direction of pneumatic port (14)  
On the side

Compressed air connection 14  
G 1/8

Working pressure min.  
-0.95 bar

Working pressure max  
16 bar

1825503149

---

Min. ambient temperature  
-25 °C

Max. ambient temperature  
70 °C

Min. medium temperature  
-25 °C

Max. medium temperature  
70 °C

Medium  
Compressed air

Max. number of valve positions  
1

Grid dimension  
71 mm

Weight  
0.34 kg

## Material

Housing material  
Die-cast aluminum

Material base plate  
Die-cast aluminum

Part No.  
1825503149

## Technical information

For use with HV series valves, the ambient temperature is -25 °C...200 °C and the medium temperature is -25 °C...120 °C.

Reversed pressure supply is not permitted for HV series valves.

The min. control pressure must be adhered to, since otherwise faulty switching and valve failure may result!

The pressure dew point must be at least 15 °C under ambient and medium temperature and may not exceed 3 °C .

The oil content of compressed air must remain constant during the life cycle.

Use only the approved oils from AVENTICS. Further information can be found in the "Technical information" document (available in <https://www.emerson.com/en-us/support>).

1825503149

Fig. 1

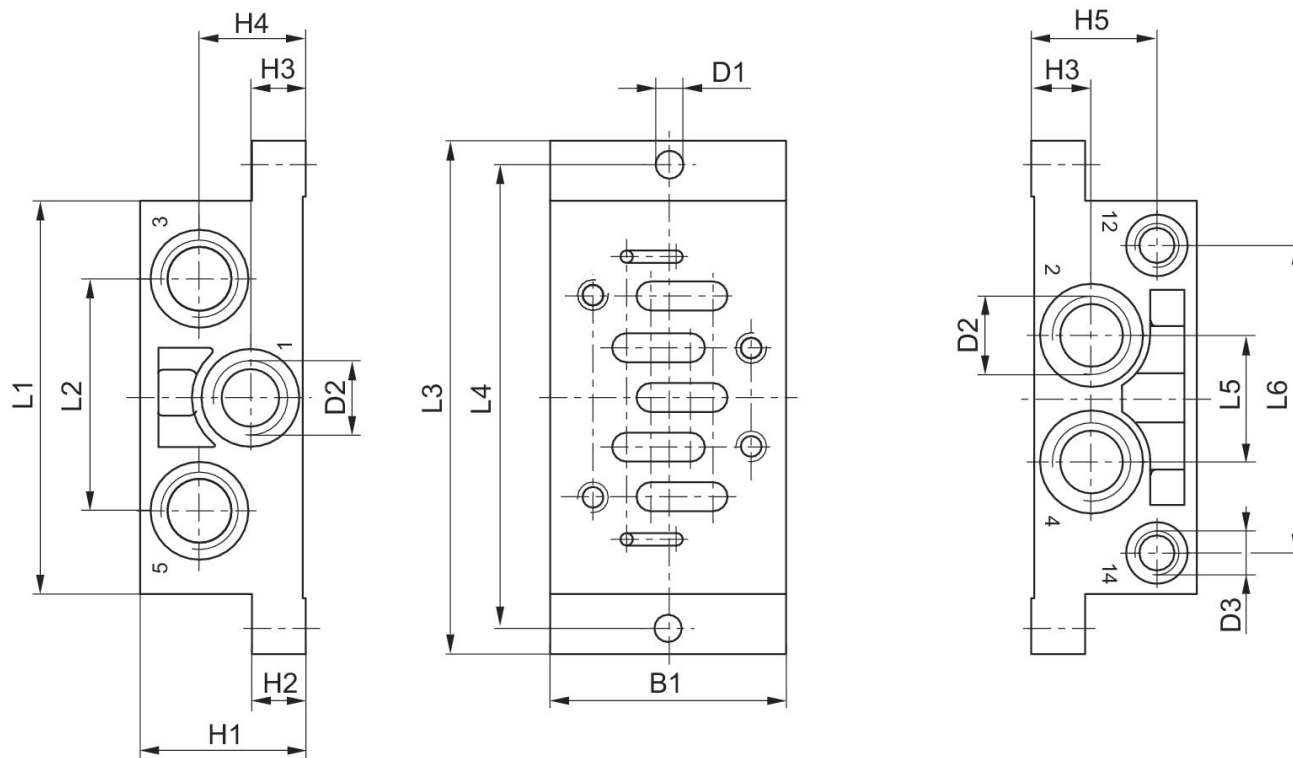

Part No.	Frame size	B1	H1	H2	H3	H4	H5	D1	D2 *)
1825503143	ISO 3	48	32	10	11,5	21.5	23.5	5.5	G 1/4
1825503146	ISO 3	57	40	13	14	26	30	6.6	G 3/8
1825503149	ISO 3	71	32	18	17	17	22	6.6	G 1/2

D3 *)	L1	L2	L3	L4	L5	L6
G 1/8	84	43	110	98	24	58
G 1/8	95	56	124	112	30	74
G 1/8	119	68	149	136	32	90

\*) Ports