



## Technical data

Industry	Industrial
Type	Base plate
Direction of pneumatic port (1)	On the side
Compressed air connection input	G 1/2
Direction of pneumatic port (2,4)	On the side
Compressed air connection output	G 1/2
Direction of pneumatic port (3,5)	On the side
Port exhaust	G 1/2
Exhaust type	Ports separated
Exhaust (3,5)	With directional exhaust (3/5)
Direction of pneumatic port (12)	On the side
Compressed air connection 12	G 1/8
Direction of pneumatic port (14)	On the side
Compressed air connection 14	G 1/8
Frame size	ISO 3
Standards	ISO 5599-1
Min. working pressure	-0.95 bar
Max. working pressure	16 bar

# Single subbase, thread connections on the side

2024-08-15

1825503149

---

Min. ambient temperature	-25 °C
Max. ambient temperature	70 °C
Min. medium temperature	-25 °C
Max. medium temperature	70 °C
Medium	Compressed air

Max. number of valve positions	1
Grid dimension	71 mm
Weight	0.34 kg

## Material

Housing material	Die-cast aluminum
Material base plate	Die-cast aluminum
Part No.	1825503149

## Technical information

For use with HV series valves, the ambient temperature is -25 °C...200 °C and the medium temperature is -25 °C...120 °C.

Reversed pressure supply is not permitted for HV series valves.

The min. control pressure must be adhered to, since otherwise faulty switching and valve failure may result!

The pressure dew point must be at least 15 °C less than ambient and medium temperature and may not exceed 3 °C.

The oil content of compressed air must remain constant during the life cycle.

Use only the approved oils from AVENTICS. Further information can be found in the "Technical information" document (available in <https://www.emerson.com/en-us/support>).

8985041104

# Single subbase, thread connections on the side

2024-08-15

1825503149

8985041204

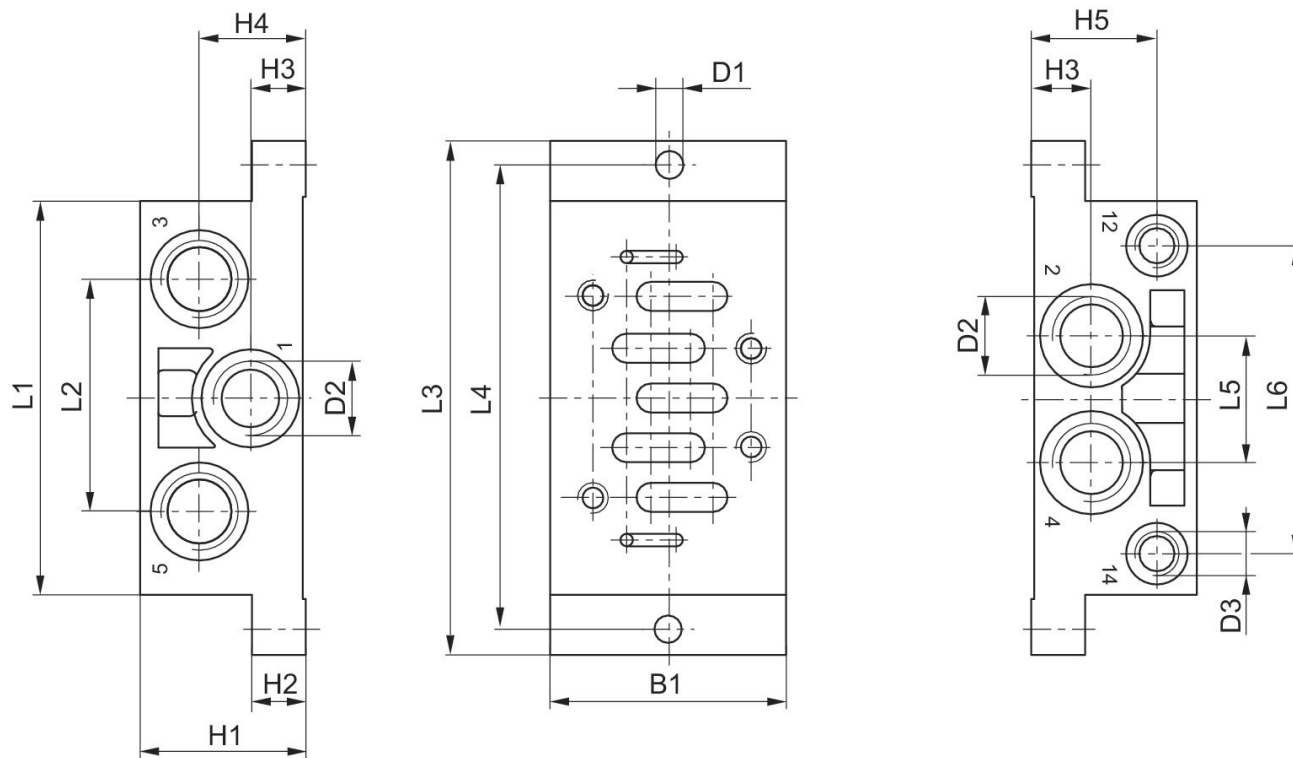

Part No.	B1	H1	H2	H3	H4	H5	D1	D2 *)	D3 *)
1825503143	48	32	10	11,5	21,5	23,5	5,5	G 1/4	G 1/8
1825503146	57	40	13	14	26	30	6,6	G 3/8	G 1/8
1825503149	71	32	18	17	17	22	6,6	G 1/2	G 1/8

L1	L2	L3	L4	L5	L6
84	43	110	98	24	58
95	56	124	112	30	74
119	68	149	136	32	90

\*) Ports