

Coupling plug with external thread

1823351027

Series CP1

2024-06-04

AVENTICS Series CP1 Couplings

The AVENTICS Series CP1 of safe couplings using single snap-on coupling are robust, safe and fit two different plug-in profiles, the EURO- profile and the ARO profile.



Technical data

| | |
|--------------------------------|----------------|
| Industry | Industrial |
| Port D | NW 7,2 |
| Port G | G 1/2 |
| Compressed air connection type | Coupling plug |
| Nominal width NW | 7.2 mm |
| Min. working pressure | 0 bar |
| Max. working pressure | 16 bar |
| Min. ambient temperature | -10 °C |
| Max. ambient temperature | 90 °C |
| Min. medium temperature | -10 °C |
| Max. medium temperature | 90 °C |
| Medium | Compressed air |
| Delivery unit | 5 piece |
| Weight per piece | 0.046 kg |
| Housing material | Brass |
| Surface housing | nickel-plated |
| | 1823351027 |

Coupling plug with external thread

1823351027

Series CP1

2024-06-04

Dimensions

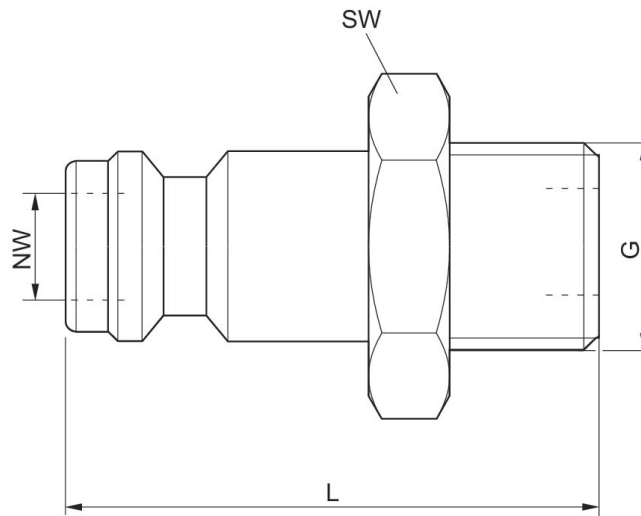

| Part No. | Port G | Nominal width NW | L | SW |
|------------|--------|------------------|----|----|
| R412028882 | G 1/4 | 7,2 mm | 33 | 17 |
| 1823351017 | G 3/8 | 7,2 mm | 33 | 19 |
| 1823351027 | G 1/2 | 7,2 mm | 35 | 24 |
| 1823351033 | G 1/4 | 7,8 mm | 33 | 17 |
| 1823351034 | G 3/8 | 7,8 mm | 33 | 19 |
| 1823351035 | G 1/2 | 7,8 mm | 35 | 24 |